

# **EZ RIDER Assembly Manual**

<b>* Front Wheel Installation .....</b>	<b>2</b>
<b>* Front Fender Installation .....</b>	<b>2</b>
<b>* Front Brake Installation .....</b>	<b>3</b>
<b>* Stem Installation .....</b>	<b>4</b>
<b>* Mirror Installation .....</b>	<b>5</b>
<b>* Paddle Installation .....</b>	<b>5</b>
<b>* Seat Installation .....</b>	<b>6</b>
<b>* Rear Fender Installation .....</b>	<b>7</b>
<b>* Rear Seat Installation ( Twin-Seat Model ) .....</b>	<b>8</b>
<b>* Carrier Installation ( Carrier Model ) ... ..</b>	<b>9</b>

**The left and right side in the following is known as the left and right side of riding position.**

**A. Front wheel installation :**

Tools : Torque Wrench (15mm Socket) × 1.

- a. Install the front-wheel into fork and fasten the nut ( Torque valve should be 424.8 in-lb ) .



**B. Front fender installation :**

Tools : Open end wrench (10mm) × 2.

- a. Install fender on the front forks as show below

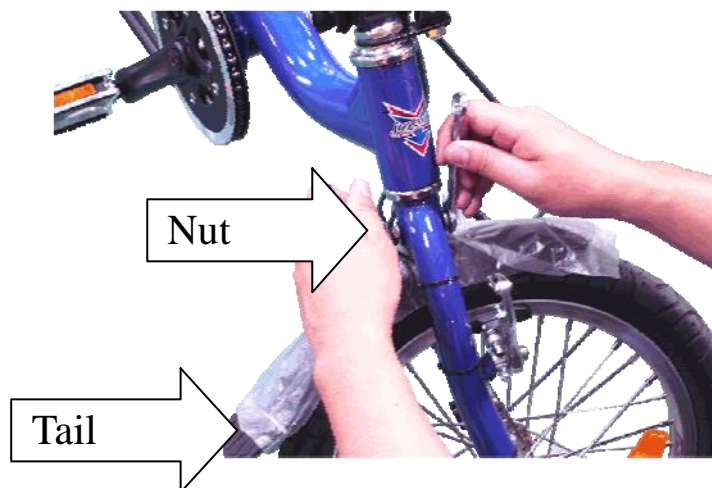

### **C. Front brake installation :**

- a. Insert part A of brake into part B.

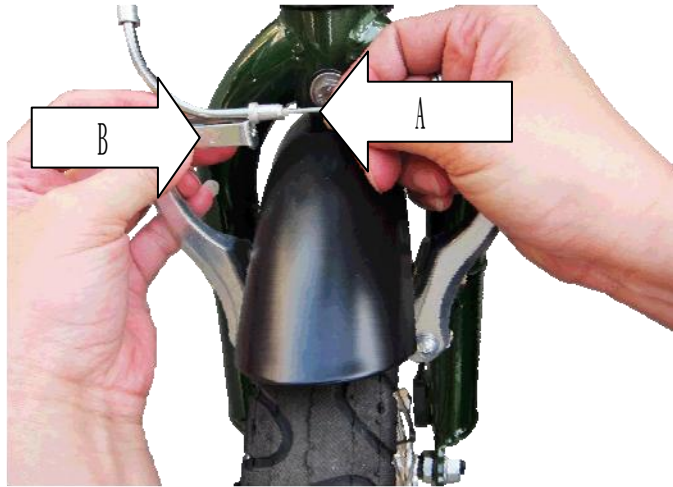

- b. Slightly adjust front brake to accurate position.

#### **D. Stem installation :**

Tools : Hex wrench (5mm) x 1.

- a. Insert stem.



- b. Set handle bar, wheel and stem vertical and make appropriate adjustment to face center line.



- c. Once the stem on accurate position, please fasten the screw to lock up.



### E. Mirror installation :

- a. Set the mirror into proper position, then fasten the screw and bolt down beneath.

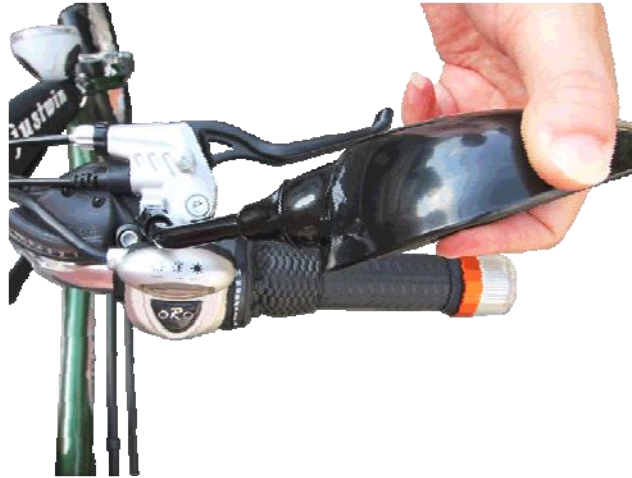

### F. Paddle installation :

Tool : Open end wrench (15mm) × 1 ◦

- a. It is different between right and left paddle. Please be careful while installation.

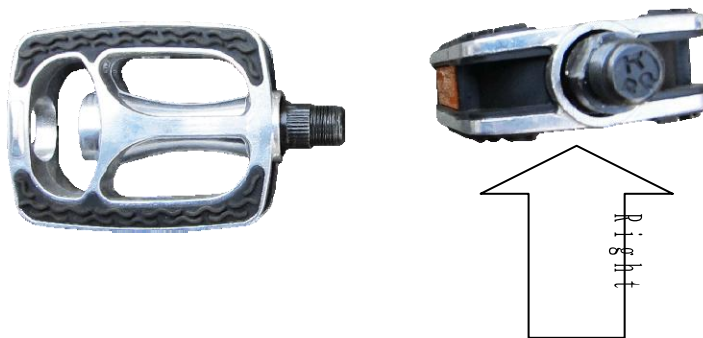

- b. Rotate the paddle clockwise to lock on properly.



## G. Seat installation :

a. Please confirm the following parts.

1. seat × 1
2. quick release × 2
3. slide block × 4

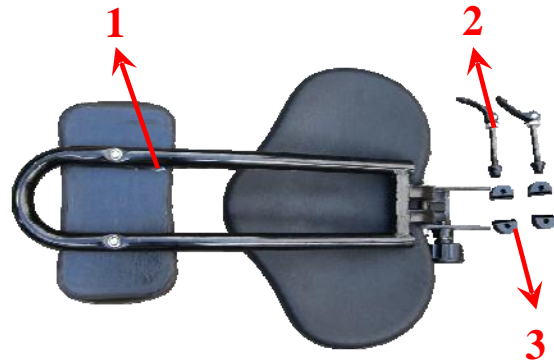

b. Place the seat parallel on the track. Unscrew the quick release then set the slide block into track.

**Slippery track**



c. Rotate the quick release to fasten up and the seat fixed.



d. Pull the knob to lift up the seat.  
(only for twin-seat model)

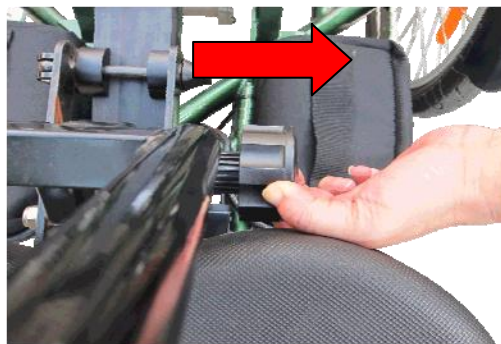

## H. Rear fender installation :

Tool : Hex wrench(5mm) × 1、Open end wrench(10mm) × 1.

- a. Set the rear fender correspond to the position of rear wheel and lock up by screw. Be careful of the direction of fender.  
( the reflector on the fender should head to trike end )



- b. Rear fender properly installed.  
( the reflector should be vertical to the ground )

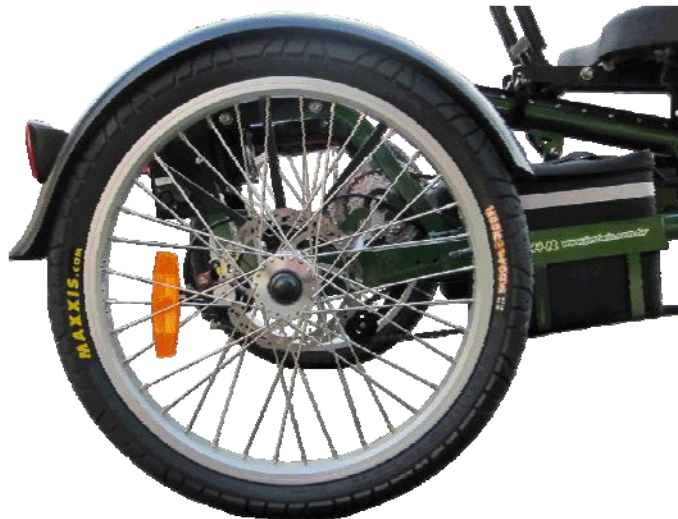

**Following installation process would differ from the trike model :**

**Twin-seat model**

**A. Rear seat installation :**

Tool : Hex wrench(6mm) × 1 · Open end wrench(13mm) × 1.

a. Please assemble following parts properly first.

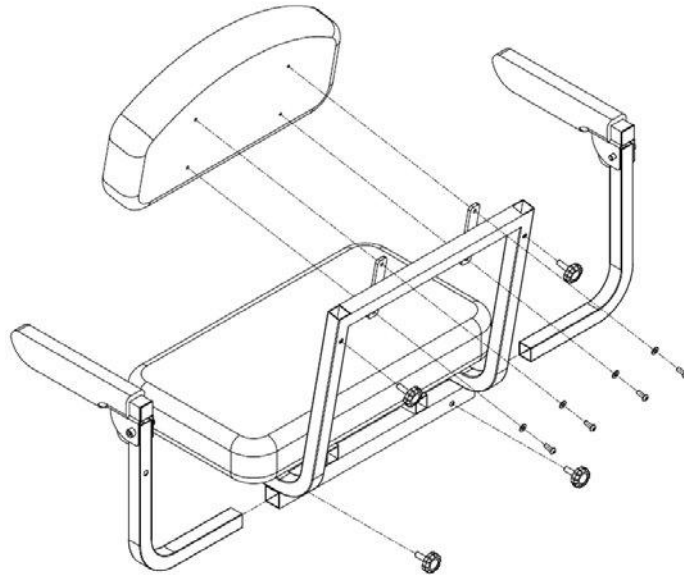

b. Place “a” part onto rear frame.

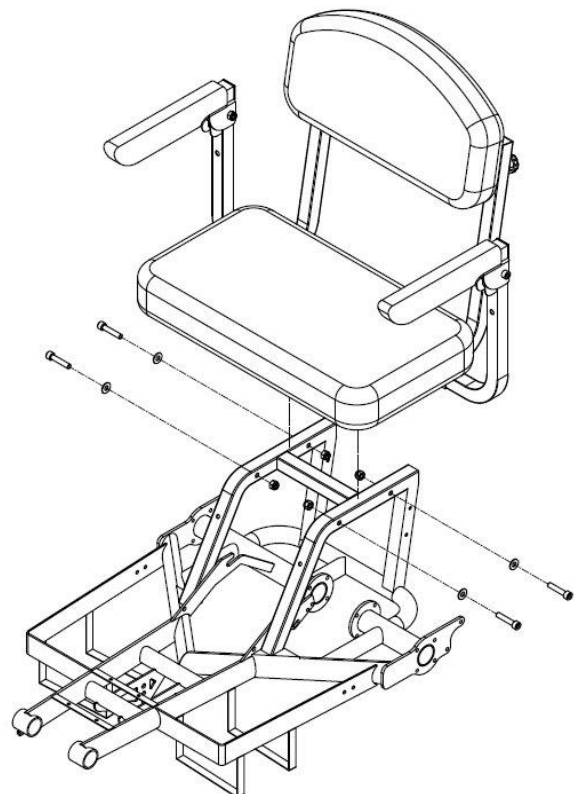

## Carrier model

### A. Carrier installation :

Insert the carrier box into rear frame as shown as red arrow on the picture.

